



KITCHEN FAUCET

Installation Instructions



LIVINGbasics

YOU MAYBE NEED:



Firstly, thanks for purchasing our products.

This instruction manual lists basin faucets for reference.

There is corresponding to installation manual for your purchased products.

with panel

- I. Screw pipe(1) on the faucet.
Place o-ring(6)below faucet.

Screw hot hose(10)and cold hose(11)
on the faucet.

Place faucet through the hole of panel and
counter.

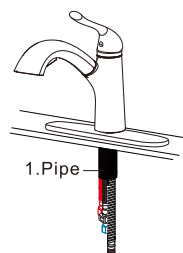

1.Pipe

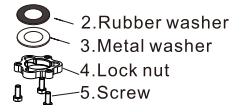

- II. Screw rubber washer(2), metal washer(3)
and lock nut(4) onto the pipe(1).

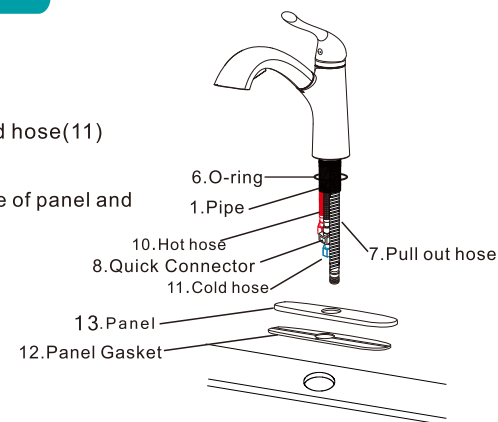

- III. Connect pull out hose (7) with
Quick Connector (8).
Assemble weight and screws(9)
on the pull out hose(7).

And then connect water supply
(not included) on the hot hose(10)
and cold hose (11).

