

TYPE FIVE:

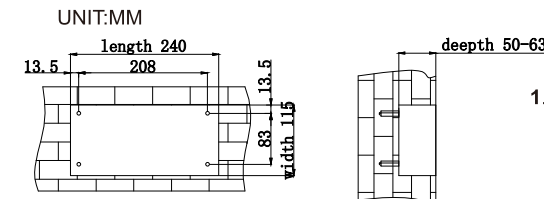

If the products you have purchased are one of these three products, pls refer to the installation procedures as follows.

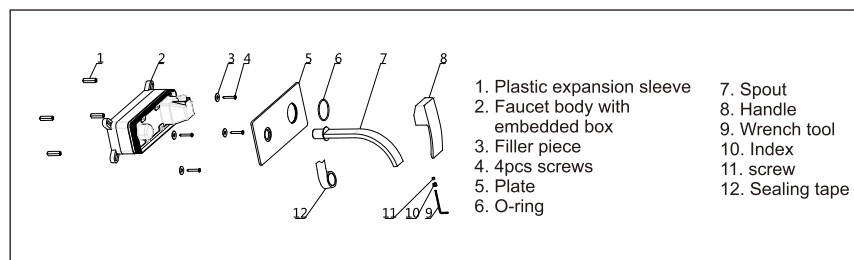

1. Dig a oblong hole and 4 mini holes, size according to upon pic show. Knock 4pcs screws into mini holes.

2. Put faucet-body into the embedded box hole , use gaske-t and 4pcs screws to make it in a fix, then connect the waterpipe properly in case of leakage.

3. Use some objects to cover the gaps around, th-en remove the protective cover with a screwdriver.

-5-

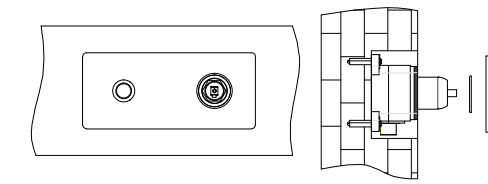

4. Put the o-ring into the plate, and insert this plate to faucet body.

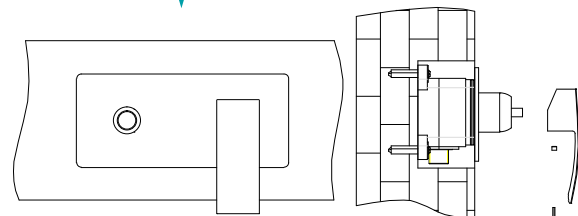

5. Put on the handle, and fix it with screw , then put on red/blue button (red on the left, blue on the right)

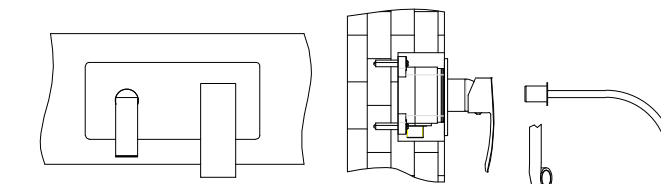

6. Seal the end of spout with the sealing tape, and spin it into the faucet-body.

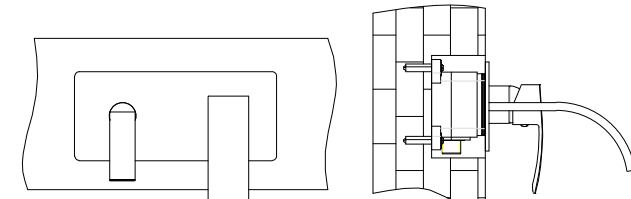

7. Installation completed. Open the handle and check whether the function is good.

-6-

TYPE SIX:

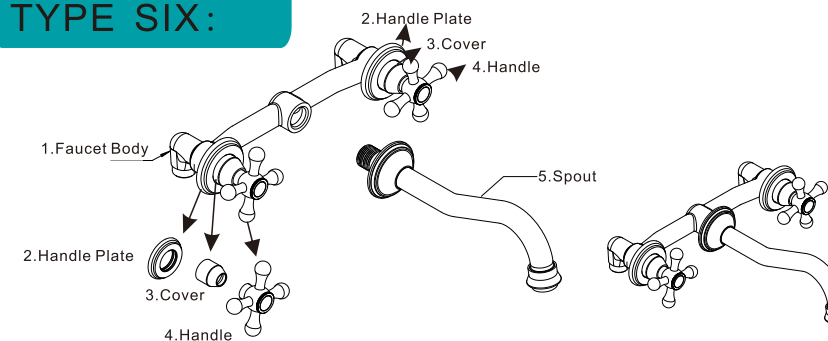

Note: No need to disassemble 2,3,4 parts before fixing it, and make sure there is no silt in water pipes.

1. Revolve handle plate(2) near to handle (4) side, Keep a little distance for installation.

2. Put faucet body (1) into wall. The water inlet is downward which is connected with water pipes. (it will be better to protect faucet surface by wrapping up with PE bag)

3. Make sure water come out without leaking, fill the wall and revolve handle plate(2) near to wall

4. Install spout to faucet body, sealed well by sealing tape, finally make sure nozzle is vertical downward

Push pop-up

1. Without overflow

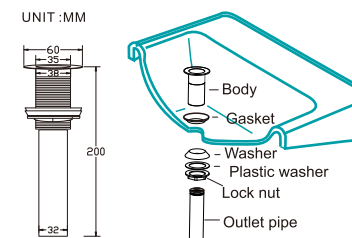

2. Without overflow

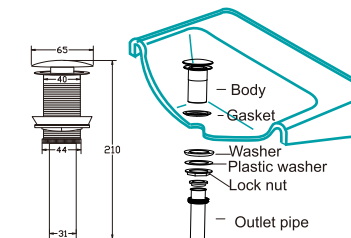

3. With overflow

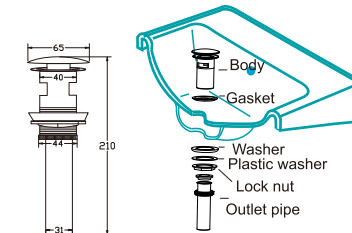

4. With overflow

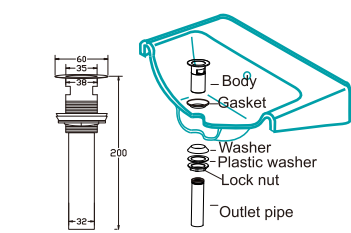

-7-



WASHBASIN FAUCET

Installation Instructions



LIVING basics

YOU MAYBE NEED:

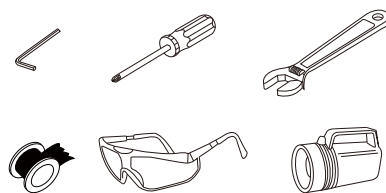

Firstly, thanks for purchasing our products.

This instruction manual lists basin faucets for reference.

There is corresponding to installation manual for your purchased products.

TYPE ONE : without base plate

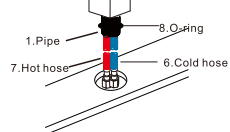
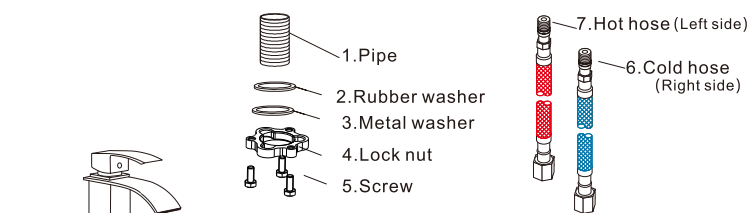

1. Place o-ring(8)below faucet.

And then put them into the hole.

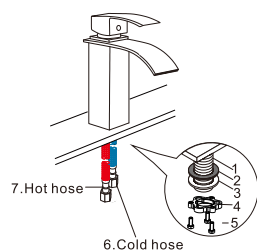

2. Screw rubber washer(2),metal washer(3) and lock nut(4) onto the pipe(1). And then connect water supply(not included) on the hot hose(7) and cold hose(6).

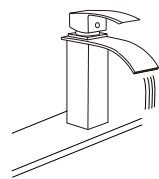

3. Open the hot and cold water supplies. Check for leaks. Turn on faucet handle for one minute to flush debris from faucet.

TYPE TWO : with base plate

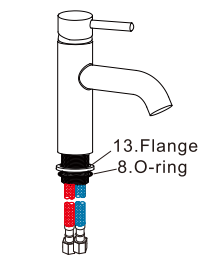
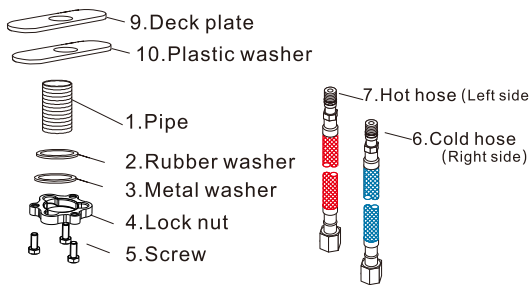

1. Put flange(13) and o-ring(8)onto the pipe(1).

And then put them into the deck plate(9), plastic washer(10) and hole.

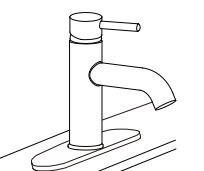
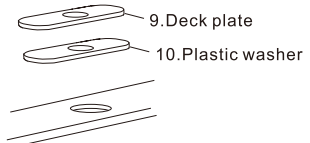

2. Screw rubber washer(2),metal washer(3) and lock nut(4) onto the pipe(1). And then connect water supply(not included) on the hot hose(7) and cold hose(6).

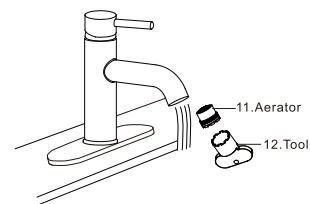

3. Open the hot and cold water supplies. Check for leaks. Turn on faucet handle for one minute to flush debris from faucet.

If the product you have purchased don't have the tools, it indicates that you do not need the tools for your product.

If water flow is too small or no water, the aerator may be blocked. If so, you should use the tool(12) to take off the aerator(11), clean it and re-install it.

TYPE THREE :

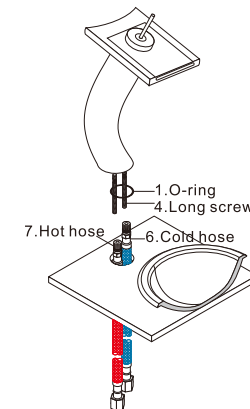
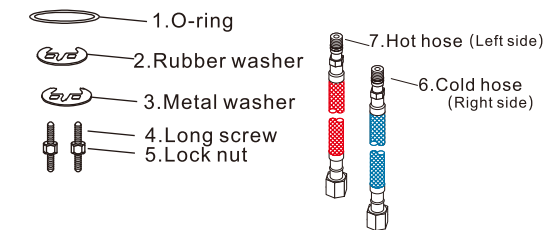

1. Screw the long screws(4) on the faucet. Place o-ring(1) below faucet and screw the hot hose(7),cold hose(6).

And then put them into the hole.

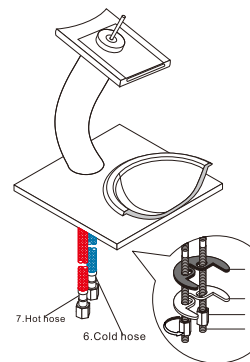

2. Tighten lock nut(5),metal washer(3) and rubber washer(2).

And the connect water supply(not included) on the hot hose(7) and cold hose(6).

3. Open the hot and cold water supplies. Check for leaks. Turn on faucet handle for one minute to flush debris from faucet.

TYPE FOUR :

Centerset faucet

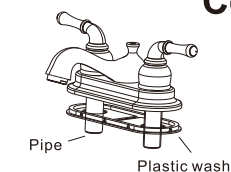

1. Put Plastic washer onto the pipe.

And then put them into the hole.

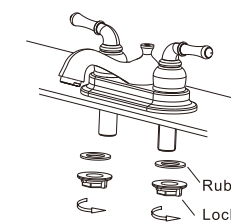
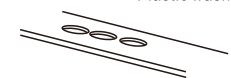

2. Screw lock nut and rubber washer onto the pipe.

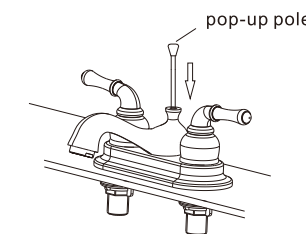

3. Put the pop-up pole through the hole.

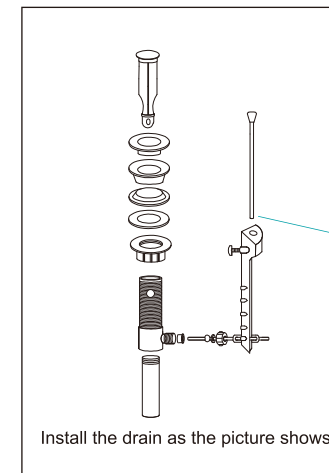

Install the drain as the picture shows

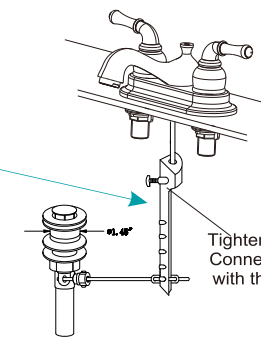

Tighten the screw to Connect the Pop-up pole with the fully-installed drain.