

User Guide

LIVINGwise

IN THE BOX

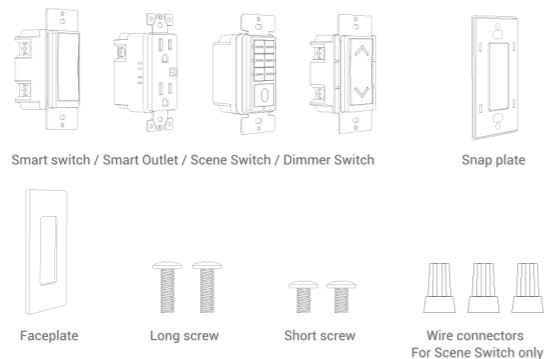

The included faceplate and snap plate are intended for single gang box installations only.
If install a double gang box, use a double gang wall plate (not included) without the faceplate and snap plate.

IMPORTANT SAFETY INFORMATION

1. This is a single pole switch and a neutral connection is required.
2. Not for humid places, such as bathroom and greenhouse.
3. Not for use with medical or life support equipment.
4. Use within the power permitted range as described in the part of SPECIFICATIONS.
5. If you are unsure or uncomfortable about performing this installation, consult a qualified electrician.
6. Keep away from children.
7. Turn off power at the circuit breaker that controls the switch before installation. It is recommended to use a circuit tester to make sure the circuit is off.

WHAT YOU'LL NEED

1. A working LivingWise hub.
3. Apple or Android smart device (tablets and desktops not supported) and a Wi-Fi network connection with a router.



2. A slotted screwdriver and a Phillips head screwdriver.



4. The LivingWise app downloaded to your smart device and register your account.



SUPPORT

Need help?
Please go to <https://support.shopperplus.com>

INSTALLATION INSTRUCTIONS

Step 1:
Remove the existing switch from the switch box. Disconnect the wiring from the existing switch. If there are no neutral wires, stop installation and consult an electrician.

Step 2:
Connect wires to corresponding wiring terminals as follows:
GREEN/BARE wire to Ground terminal;
WHITE wire to Neutral terminal;
BLACK wire to Hot terminal;
RED wire to Load terminal.
Your home's wirings may vary, please consult an electrician.

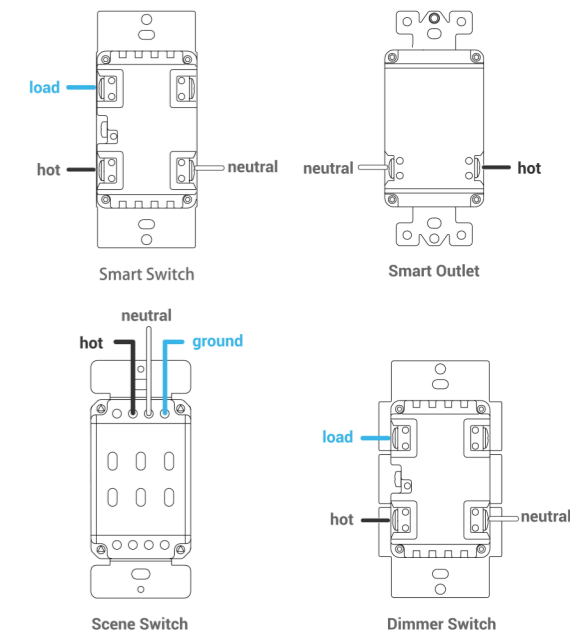

Step 3:
Double-check to confirm wirings are correct. Place the switch into wall and mount using the long screws from the existing switch.

Step 4:
Mount the short screws into the snap plate, and press the faceplate onto the snap plate.

Step 5:
Turn on power at the circuit breaker. Press each button to make sure the switch is wired correctly.
As shown in Figure 1 and Figure 2.

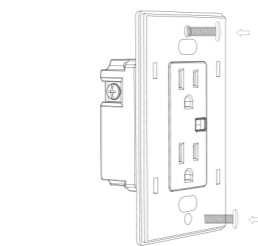

Figure 1

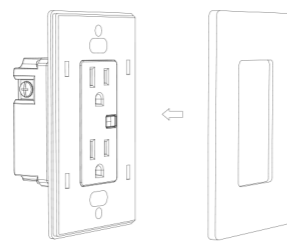

Figure 2

CONNECT TO THE LivingWise APP

Step 1:
Press and hold the button on LivingWise hub until green light starts to flash.

Step 2:
Turn on power at the circuit breaker, then the blue led light starts to flash. If the blue led light is always on or flashing quickly, restore factory settings.

Step 3:
Open the LivingWise app and add your smart device step by step through the LivingWise app.
As shown in Figure 3.

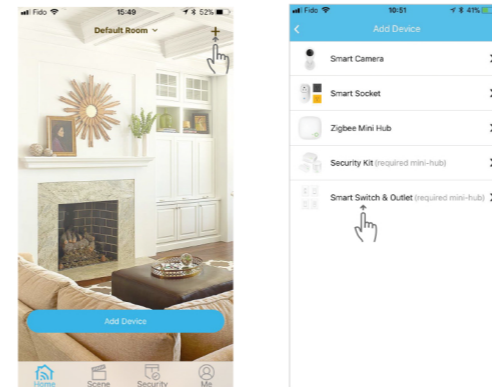

Figure 3

RESTORE FACTORY SETTINGS

Press any button four times continuously, and hold on when pressing fifth time until the blue led light blinks quickly. Then press any button again after 5 seconds to get into pairing state.

SPECIFICATIONS

Smart Switch
Size/weight: 104x44x46mm / 181g(4.1"x1.7"x1.8"/6.4oz)
Operating temperature: -4°F~104°F
Voltage: 120VAC, 60Hz
Load power: 1800W(resistive) / 1000W(incandescent) / 0.5HP(motor) / 1200VA(ballast)

Smart Outlet
Size/weight: 104x44x46mm / 155g (4.1"x1.7"x1.8"/5.5oz)
Operating temperature: -4°F~104°F
Voltage: 120VAC,60Hz
Load power: 1800W(resistive) / 1000W(incandescent) / 0.5HP(motor) / 1200VA(ballast)

Scene Switch
Size/weight: 104x44x46mm / 140g(4.1"x1.7"x1.8"/5oz)
Operating temperature: -4°F~104°F
Voltage: 120 / 270VAC, 50 / 60Hz

Dimmer Switch
Size/weight: 104x55x46mm/165g(4.1"x2.2"x1.8"/5.8oz)
Operating temperature: -4°F~104°F
Voltage: 120VAC, 60Hz
Load power: 500W(resistive) / 500VA(capacitive and motor)

Wireless protocol: ZigBee HA
RF frequency: 2.4GHz,IEEE 802.15.4
Encryption mode: AES-128bit dynamic encryption
Wireless operation distance of up to 200ft from other Hubs or Switches (in open air)